













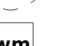

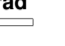

-  toilet (gestippeld optioneel)
-  wastafel
-  douche met vloergoot
-  wtw warmterugwinunit
-  wp warmtepomp
-  optioneel extra boiler vat
-  wm wasmachine aansluiting
-  wd wasdroger aansluiting
-  rad elektrische handdoekradiator
-  vv verdeler vloerverwarming
-  vloerverwarming
-  ventilatieventiel (in plafond)
-  schacht
-  entree woning
-  deur, brandwerend en zelfsluitend
-  deur
-  draaikiepraam
-  tegelwerk
-  gekrijtstreepte oppervlakte



1 : 100 VOORGEVEL (ZUID)



1 : 100 ACHTERGEVEL (NOORD)

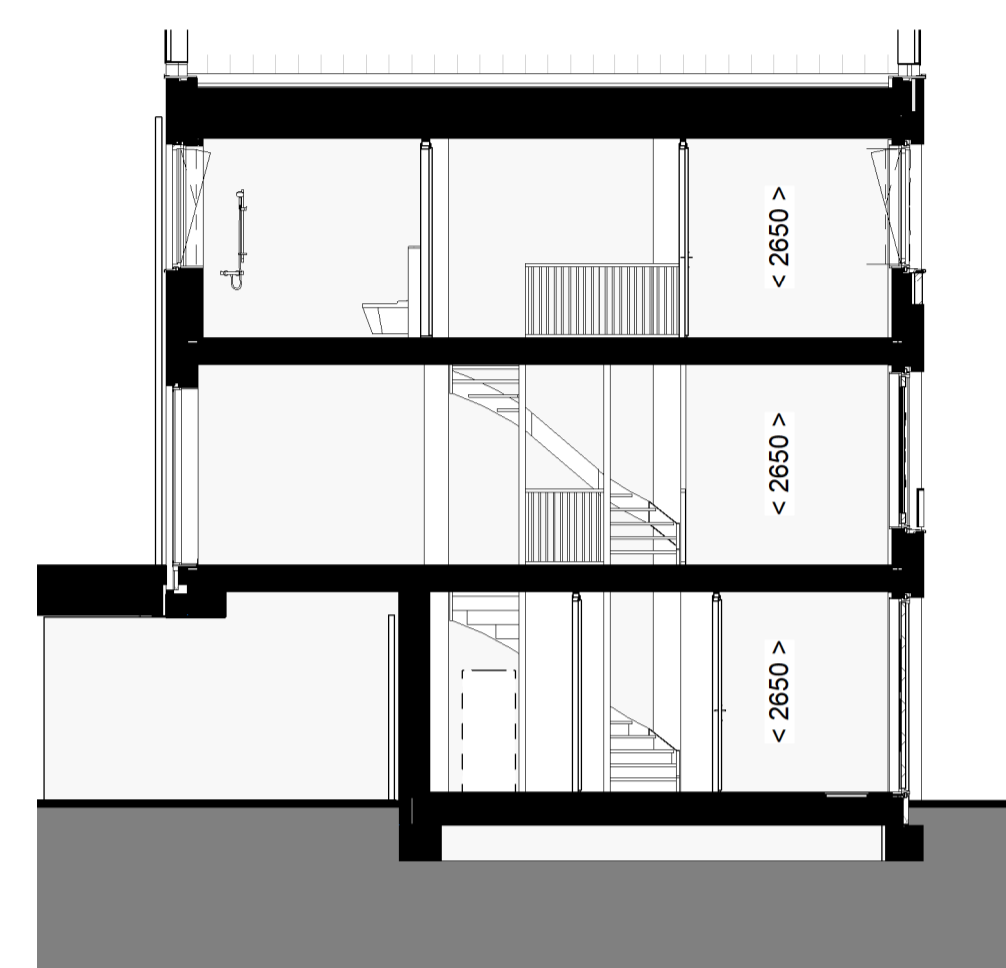

1 : 100 DOORSNEDE

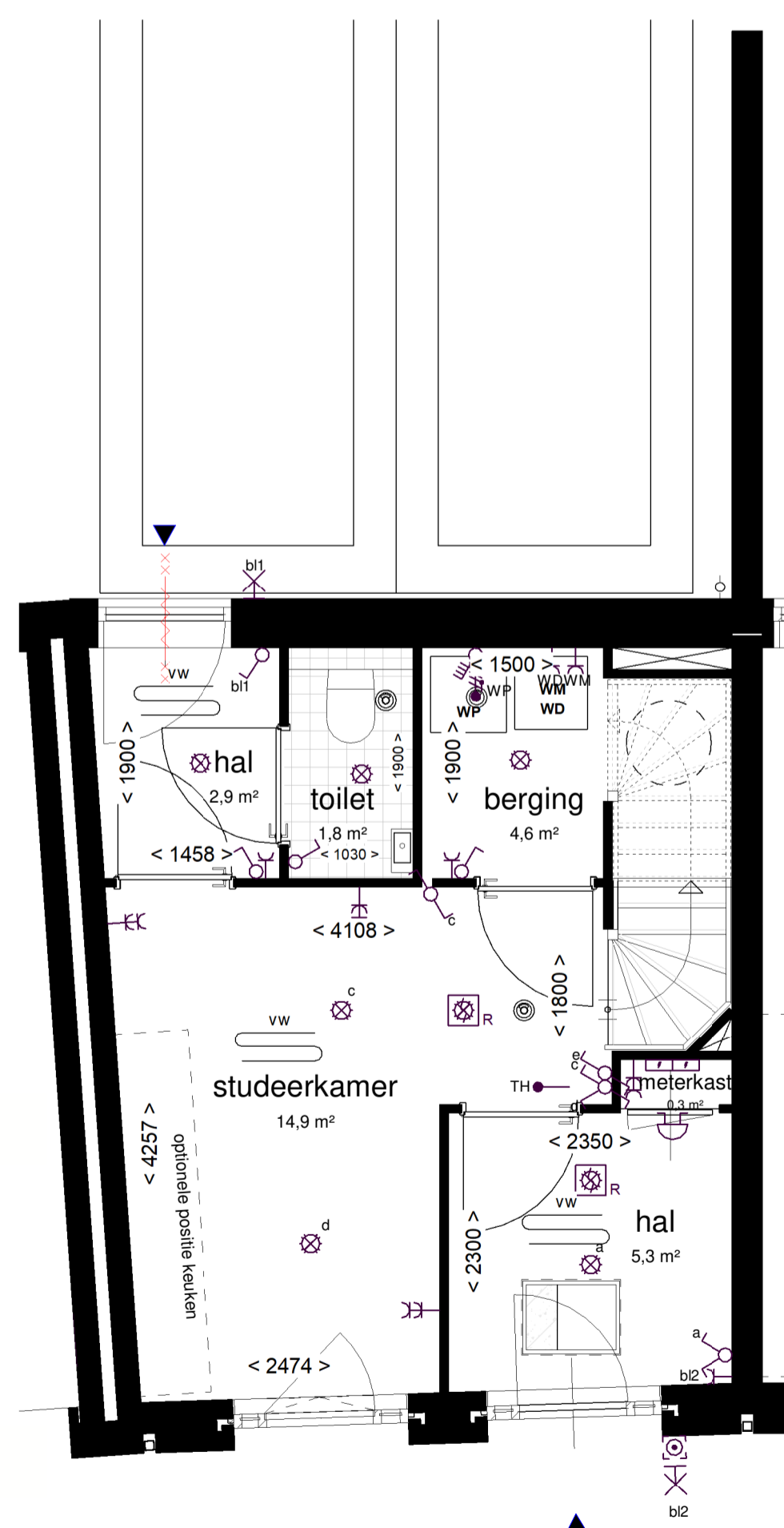

1 : 50 BEGANE GROND

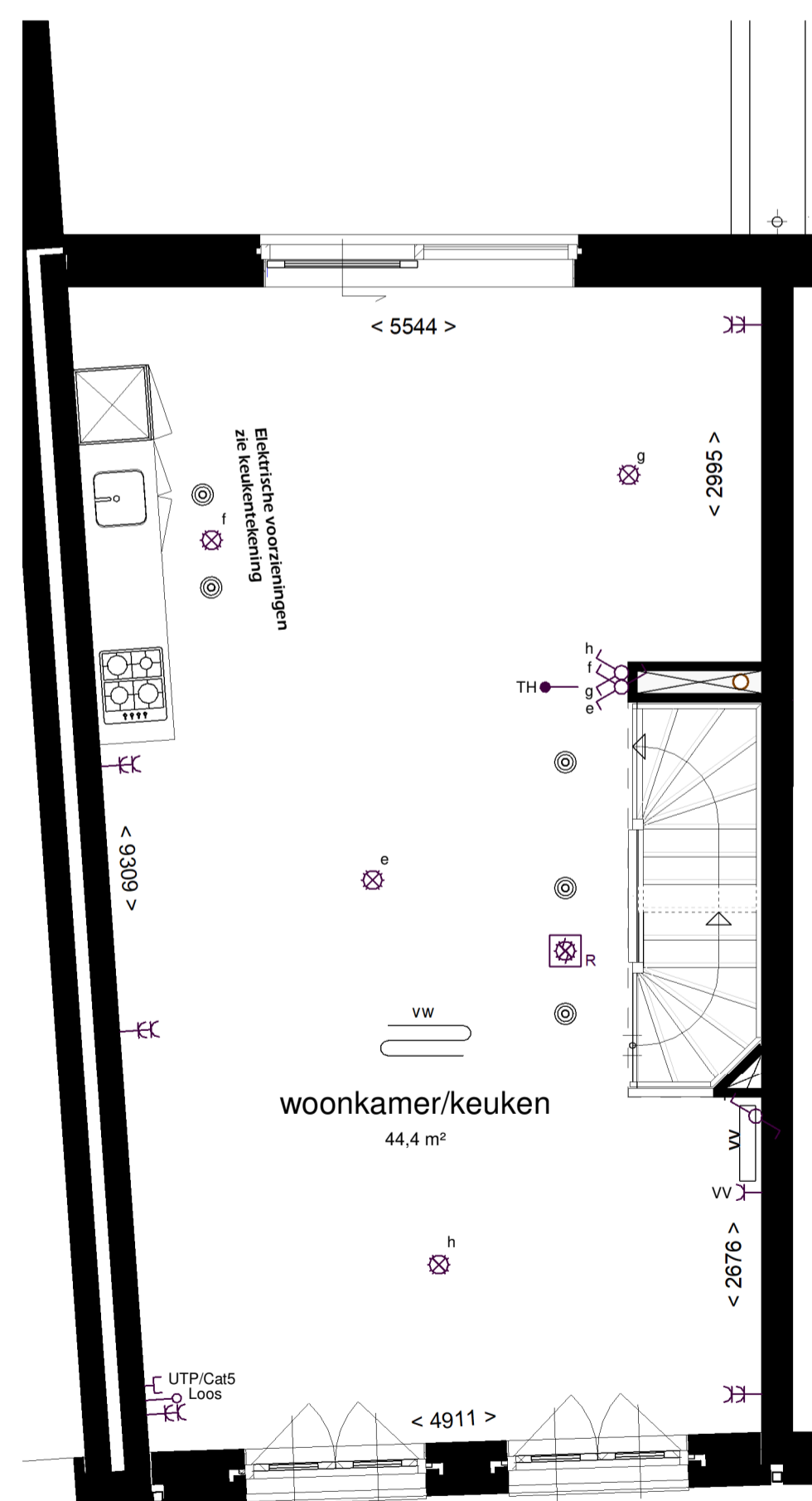

1 : 50 1e VERDIEPING

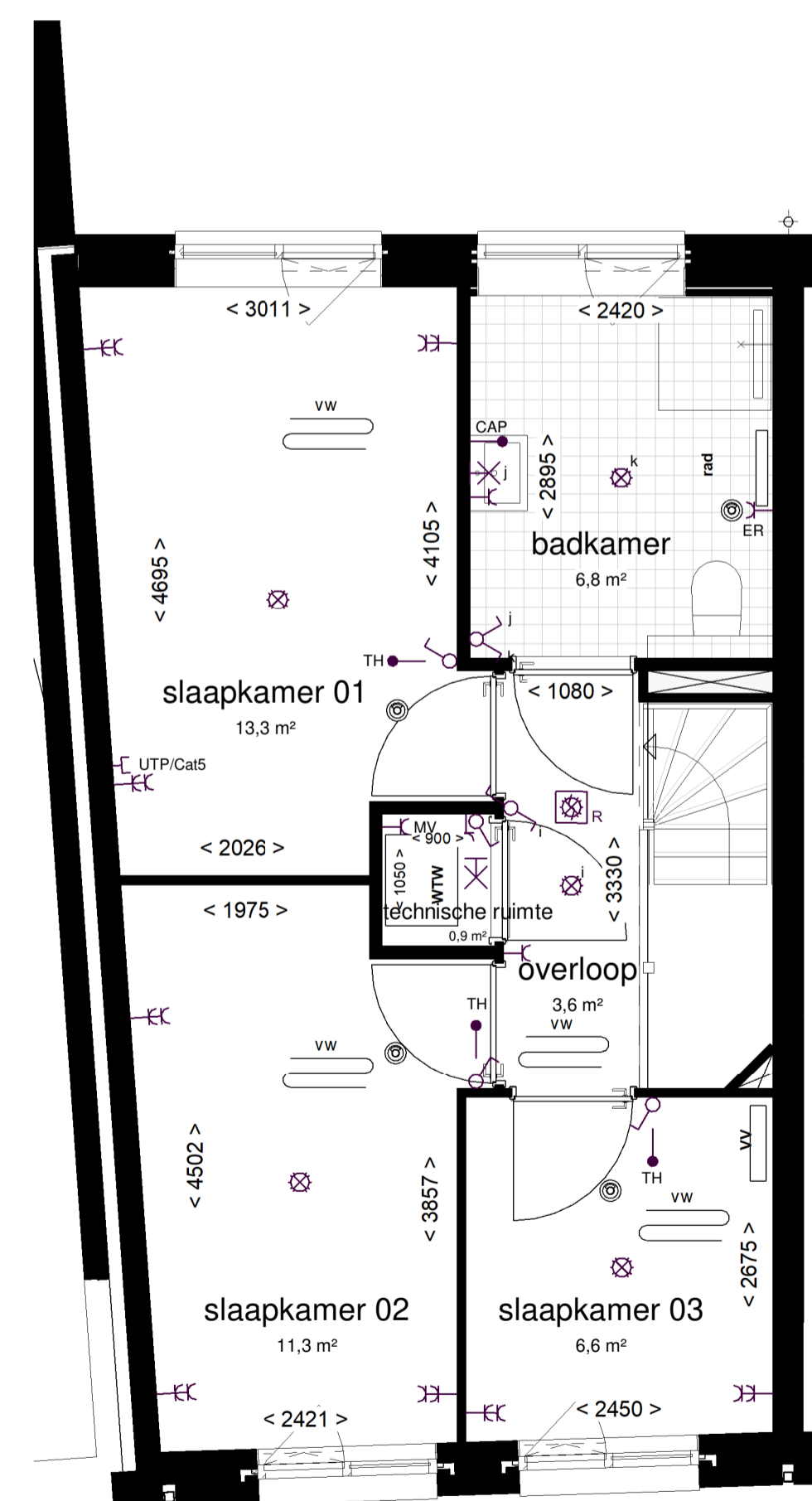

1 : 50 2e VERDIEPING

Relevant Elektrische Installatie Woning	
	Combinatie
	Aankoopkast voor wand Aansluiting
	Aankoopkast met wandcontactdoos
	Elektronische schakelaar
	Elektronische schakelaar met combinatie
	Wand schakelaar
	Stoep schakelaar
	Elektrische wandcontactdoos
	Elektrische Wandcontactdoos (verlengd geschikt)
	Elektrische Wandcontactdoos (aanbouw geschikt)
	Elektrische opbouwcontactdoos
	Prakker wandcontactdoos 1.5 x 1.5m (Kortkast) (2/250V)
	Zakdoos aansluiting 1.5 x 1.5m (Data of CAU)
	Loze bedrading (niet meten)
	Bedrading (niet meten)
	230V aansluiting
	Overspanning
	Stroomkast
	Wandcontactdoos (2/250V)
	Stroomkast (230V (afgevoerd))
	Vloerverwarming met wandcontactdoos 1.5 x 1.5m (overeenkomstig met de aansluiting van de vloerverwarming)
	Vloerverwarming met wandcontactdoos overspanning
	Vloerverwarming met wandcontactdoos

